

SPLICING SOCKS - ROTATING BARREL

⚠ WARNING

Cancer and Reproductive Harm: www.P65Warnings.ca.gov



KEY FEATURES

- ✓ Eliminates twist
- ✓ Wide range of options (0.25" - 4.25")

Slingco Rotating Barrel Swivel socks have a swivel barrel that rotates when being used in straight line pulling applications to remove torsion.

Do not use for overhead line work. Two socks and a swivel are recommended for overhead line pulls.

Please note: rotating barrel should not be used over a pulley as it may be too long to clear turns.

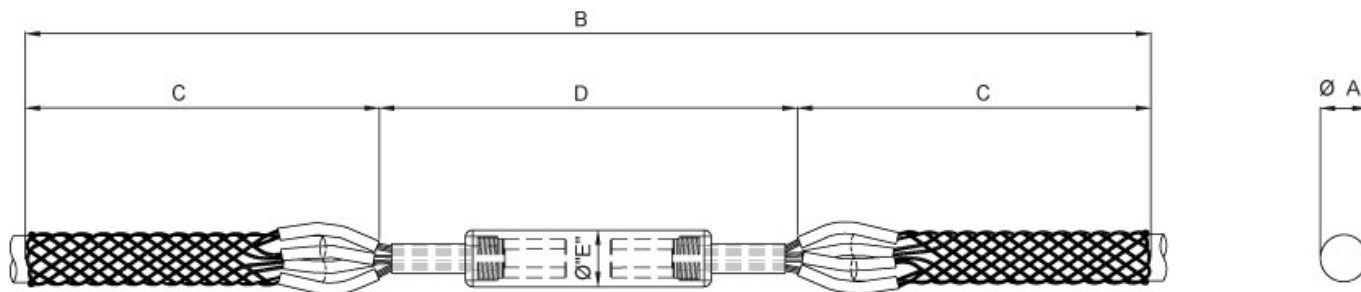

L9, 1 York Street, Sydney, NSW 2000, Australia Sales: +61 3 8840 6556

GET IN TOUCH

+61 3 8840 6556

sales@slingcoaustralia.com.au

SPLICING SOCKS - ROTATING BARREL

Slingco Part No.	Range (mm)	Range (in)	Ø A Length (mm)	Ø A Length (in)	B Length (mm)	B Length (in)	C Length (mm)	C Length (in)	D Length (mm)	D Length (in)	Ø E Length (mm)	Ø E Length (in)	Approx. Break Load (kg)	Approx. Break Load (lb)
ZCS3505	6-13	0.25 - 0.50	9.5	0.37	1,680	66.1	755	29.7	170	6.7	23	0.9	1,964	4,400
ZCS3506	13 - 25	- 1.00	19	0.75	2,230	87.8	1,015	40.0	200	7.9	25.4	1.0	3,304	7,400
ZCS3507	25 - 38	- 1.50	32	1.25	2,030	79.9	895	35.2	240	9.5	36	1.4	4,530	10,000
ZCS3508	38 - 51	- 2.00	44.5	1.75	1,830	72.0	795	31.3	240	9.5	36	1.4	5,357	12,000
ZCS3509	51 - 70	- 2.75	60.5	2.38	2,180	85.8	940	37.0	300	11.8	41	1.6	7,142	16,000
ZCS3510	70 - 90	- 3.50	80	3.15	2,730	107.5	1,195	47.0	340	13.3	48.5	1.9	8,928	20,000
ZCS3511	89 - 108	- 4.25	98.5	3.87	2,650	104.3	1,130	44.5	390	15.3	48.5	1.9	10,714	24,000

This information is for marketing purposes only. The details contained herein is presented as general information and no representation or warranty is expressly or impliedly given as to its accuracy, completeness or correctness. It does not constitute part of a legal offer or contract. For technical specifications, please contact Slingco Australia Pty. Ltd

Dimensions

The figures shown are indicative only. Fully dimensioned data-sheets are available on request. Nominal figures/actuals are as per data-sheet with tolerances of +/-10%. Please contact us if you have any questions.

Range dimension overlaps If the cable, rope or hose you have lies where ranges overlap, e.g. 1" when sizing is 0.5-1.00 and 1.00-1.5 we recommend that you select your cable grip to achieve break load first. If tensile strengths are equal or both adequate, choose the smaller of the two. Please contact us if you have any questions.



L9, 1 York Street, Sydney, NSW 2000, Australia Sales: +61 3 8840 6556

GET IN TOUCH



+61 3 8840 6556



sales@slingcoaustralia.com.au