

ANTI-ROTATIONAL DEVICE (ARD)



KEY FEATURES

- ✓ Stops cables from twisting as they pass over pulling blocks
- ✓ Suitable for fibre optic and OPGW cable
- ✓ Prevents damage to delicate fibre optics from cable twists
- ✓ Travel easily over pulling blocks

The device prevents the cable from twisting as it travels over pulling blocks. Left uncontrolled, the optical cable's delicate glass fibers could be permanently damaged during installation.

- Stops cables from twisting as they pass over pulling blocks
- For use with fiber optic and OPGW cable
- Prevents irreparable damage to delicate fiber optics caused by cable twists during installation
- The ARD has weighted attachments that hang down while stringing, keeping the ARD vertical to stop cable rotation
- ARD attachments collapse in line, enabling them to travel easily over pulling blocks
- The ARD includes one 5,000 lb swivel attached to the head of the device



GET IN TOUCH



1 888 685 9478



sales@slingcoamerica.com

ANTI-ROTATIONAL DEVICE (ARD)

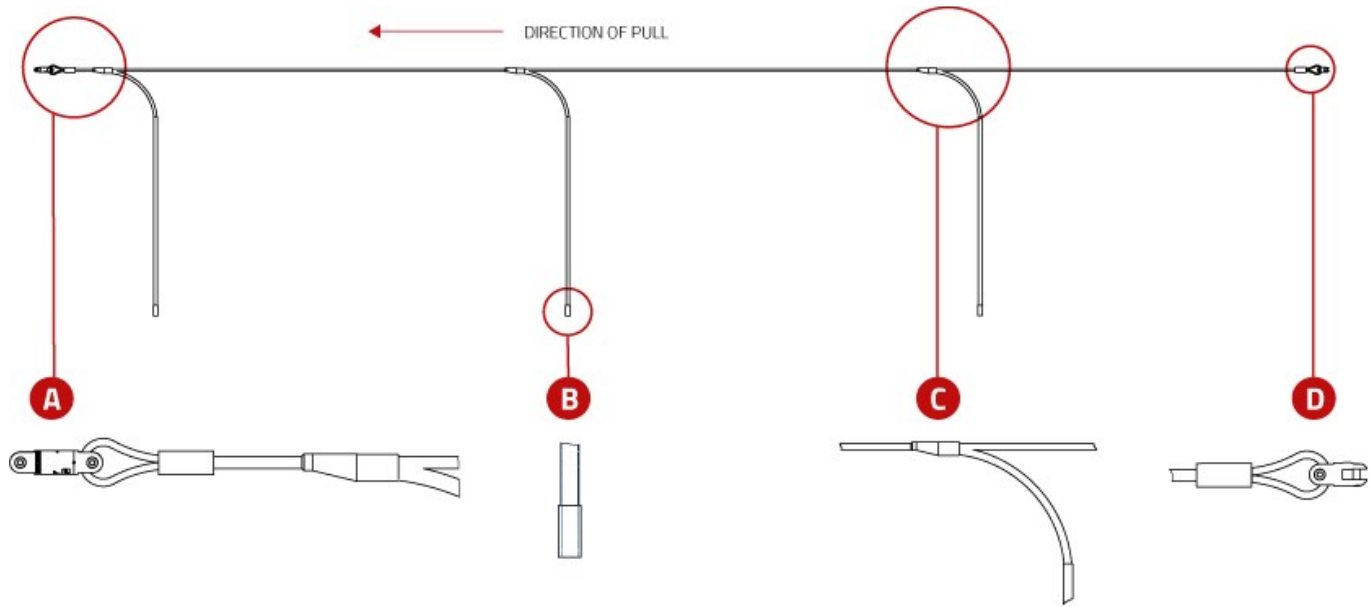

Slingco Part No.	Overall Length (in)	Overall Length Approx (mm)	Approx Working load @3:1 Safety Factor (lb)	Working Load @3:1 Safety Factor (kg)	Length of Attachments Approx (in)	Length of Attachments Approx. (mm)	Weight of each Attachment (lb)	Weight of each Attachment (kg)
ZAD3799	348	8839	5,000	2268	96	2438	14	6.35

This information is for marketing purposes only. The details contained herein is presented as general information and no representation or warranty is expressly or impliedly given as to its accuracy, completeness or correctness. It does not constitute part of a legal offer or contract. For technical specifications, please contact Slingco America, Inc.

Dimensions

The figures shown are indicative only. Fully dimensioned data-sheets are available on request. Nominal figures/actuals are as per data-sheet with tolerances of +/- 10%. Please contact us if you have any questions.

Range dimension overlaps If the cable, rope or hose you have lies where ranges overlap, e.g. 1" when sizing is 0.5-1.00 and 1.00-1.5 we recommend that you select your cable grip to achieve break load first. If tensile strengths are equal or both adequate, choose the smaller of the two. Please contact us if you have any questions.



GET IN TOUCH



1 888 685 9478



sales@slingcoamerica.com